

METAL TERMINATION BAR
FASTENED 12" O.C.
REF. DETAIL W-9 AND 10B
FOR ALTERNATE TERMINATIONS

FLEX-FLASH UN

FOAM ROD OR TUBE

HYDROFLEX 30 OR OTHER
APPROVED PROTECTION

MONOLITHIC
MEMBRANE 6125-FR

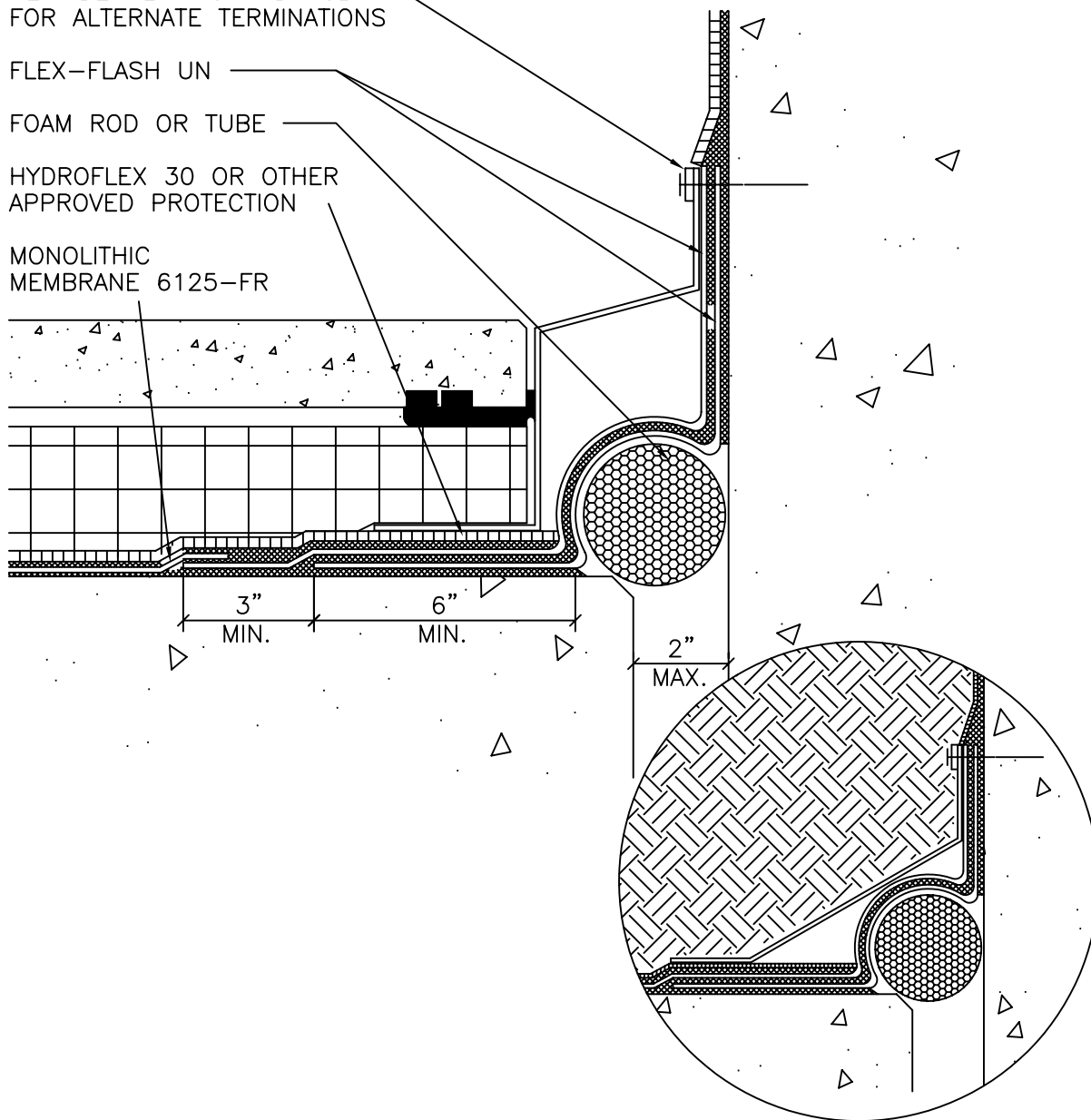

NOTES: DETAIL DESIGNED TO ACCOMMODATE MAXIMUM 50% TOTAL MOVEMENT.

BACKER ROD SHOULD BE A MINIMUM 1" LARGER IN DIAMETER THAN MAXIMUM AS-BUILT JOINT OPENING.

IN COVERED/BURIED CONDITIONS, ADEQUATE PROTECTION MUST BE PROVIDED FOR FLASHING FROM SUBSEQUENT TOPPING/BACKFILL. WHENEVER POSSIBLE THE EXPANSION JOINT SHOULD BE EXTENDED UP THROUGH ALL TOPPING LAYERS.



Monolithic
Membrane
6125-FR
WATERPROOFING SYSTEMS

AMERICAN HYDROTECH, INC.

DECK-TO-WALL EXPANSION JOINT
1"-2" MAX. AS-BUILT WIDTHS

3"=1'-0"
(EXCEPT INSET)

W-6C